



VKX05 // for insertion installation



VKX05

Your advantages

Series	VKX05
	<ul style="list-style-type: none"> • Direct installation into pipe lines DN 50...150 • Sealed with integrated O-ring

Technical data	VKX05
Switching function	Contact closes at increasing flow
Nominal diameter range	Applicable in DN 50...150
Pressure rating	PN 10
Temperature ranges	
Medium	-20...100 °C
Ambient	-20...70 °C
Electrical data	
Electrical connection	1.5 m PVC jacket cable
Degree of protection EN 60529	IP65
Max. Switching current	Max. 1 A
Max. Rating	Max. 26 VA, 20 W
Max. Switching voltage	230 VAC, 48 VDC or 24 VAC, 42 VDC
Protection class EN 60730-1	Class II or Class III
Approvals	
 	

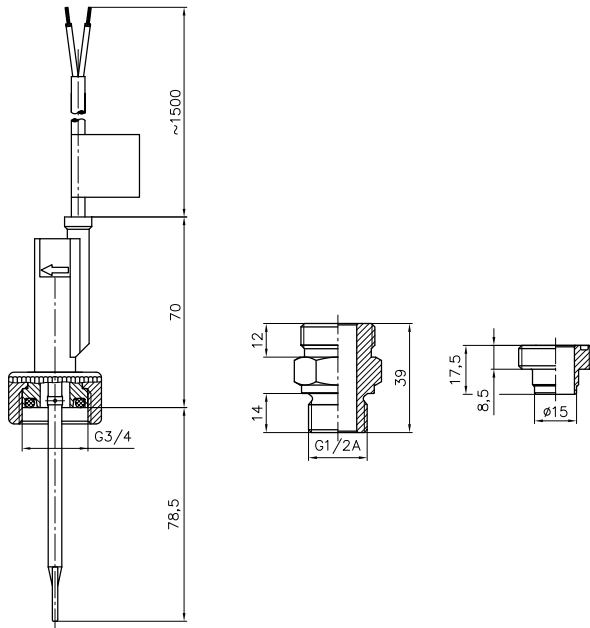

Materials in contact with fluid	
Type	VKX05
Body	PPE+PS Noryl™ 30 % glass fibre reinforced
Paddle	PPE+PS Noryl™ 30 % glass fibre reinforced
Pin	Stainless steel 1.4571 or titanium
Magnet	Hard ferrite
O-ring	EPDM
Soldering adapter	Brass CW614N
Process connection	Brass CW614N or stainless steel 1.4571

Order code			
Type			
VKX05	VKX05M2P2		
VKX05 with titanium pin	VKX05M2B2		
Switching voltage			
230 VAC, 48 VDC		AP	
24 VAC, 42 VDC		BP	
Process connection			
Union nut G ³ / ₄			U10
Threaded adapter G ¹ / ₂ brass			R21
Threaded adapter G ¹ / ₂ stainless steel			R23
Soldering adapter			D11
Example order number	VKX05M2P2	AP	U10